

# Interactive Panel Touch Screen User Manual



## Signal Source Selection

The following three ways are used to select a signal source:

- Press **SOURCE** on the remote controller.
  - Press **Source** on the control panel of the interactive touch screen.
  - At Main page or Whiteboard mode, click  for input Source selection page.
  - In the signal source page, press **▲**, **▼**, **◀** or **▶** to select a channel and press OK.
- You can also select directly by clicking an icon, as shown in the following figure:

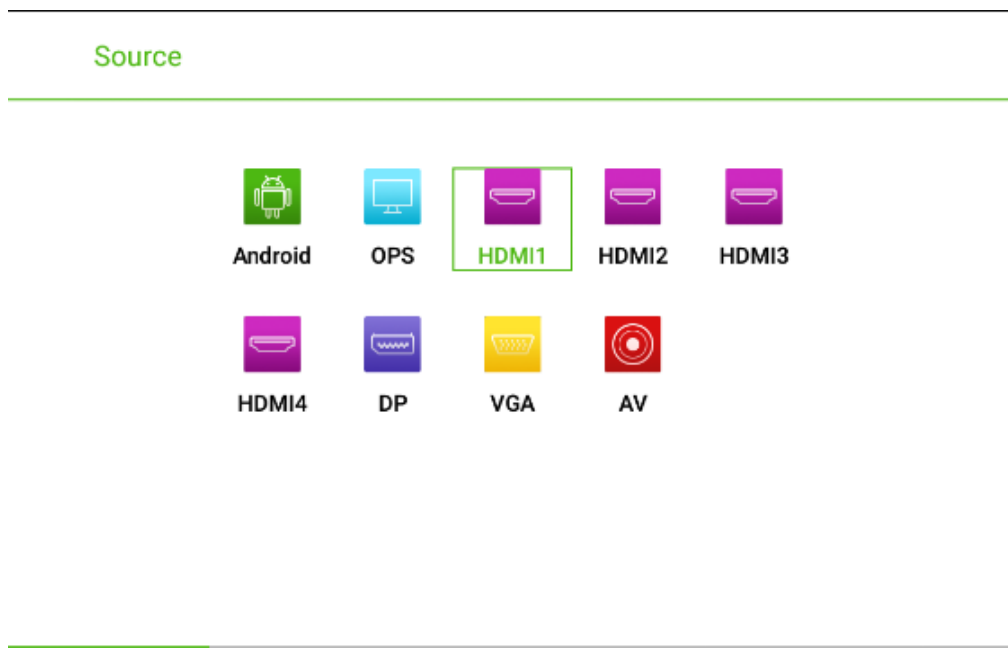

**Please note that the source will typically be set to VGA, however will on occasion need to be HDMI. Please check the computer itself for indicators as to which source input to use.**

## Power off

**Step 1** Press PC Power to turn off the OPS (for all-in-one models only).



**Step 2** Press Power on the control panel or Power on the remote controller to enter the standby mode. The screen will show the following information.

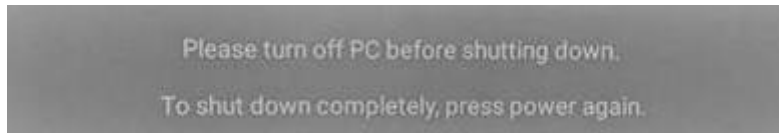

**Step 3** Press Power on the control panel or Power on the remote controller to confirm and pass to the Standby mode. The power indicator turns red.

**Step 4** In the standby mode, switch off the rocker switch to turn off the interactive touch screen.



### WARNING



- Please turn off the OPS before you turn off the interactive touch screen. Otherwise, the computer may be damaged.
- Disconnect the interactive touch screen from power after the screen enters standby mode. Otherwise, the screen may be damaged. A sudden power failure may damage the interactive touch screen.
- Frequent power on and off in a short time may cause faults.

Status of the power indicator is as follows:

Power indicator	Status
No light	Powered off
Red	Standby
Green	Powered off



## Toolbar Introduction

The toolbar has three modes: Home Page, Task Manager, and Whiteboard.

Under any of the three modes, you can click  on the toolbar to go back to the previous page and click  to exit from other programs or go back to the home page from other signal sources.

- On the home page, the toolbar is under home page mode and shows icons of the task manager, signal source, white board, input signal, file manager, system setting, browser and search engine. You can click an icon to open the corresponding program.



- After the whiteboard program is started, the toolbar enters the whiteboard mode, in which you can choose a pen, line weight and color to write on the whiteboard.
  - If you want to use the whiteboard function with non-signal model, Click  on the displayed menu, the **New Page, Overview, Delete All** and **Settings** functions are listed.
  - If you want to use whiteboard function with signal model, please click the  icon to enter the menu setting interface.



- In programs other than the whiteboard, the toolbar is in the Remarks mode. You can select a pen, line weight and color to write and add remarks on the opened file (including image, PPT and PDF). Click  on the right to hide the toolbar. Scroll up with your finger to display the toolbar.

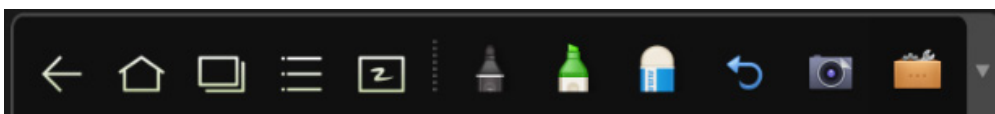

## Task Manager

In the task manager, you can view current running programs, switch and end programs. Click  to enter the task manager as shown in the following figure:

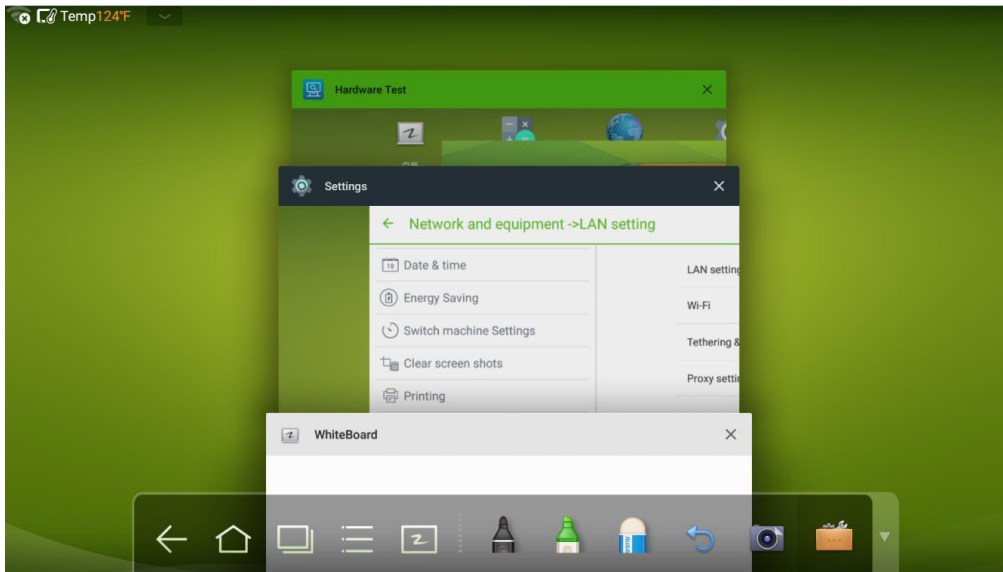

## View Running Programs

In the task manager, scroll up and down to view the current running programs.

## Switch Programs

In the task manager, click an application program icon to switch programs. For example, click **Settings** to switch to the system setting application program, or click **Browser** to switch to the browser application program.

## End Programs

In the task manager, select a program, click the  icon of top right corner or scroll right or left to end the program.

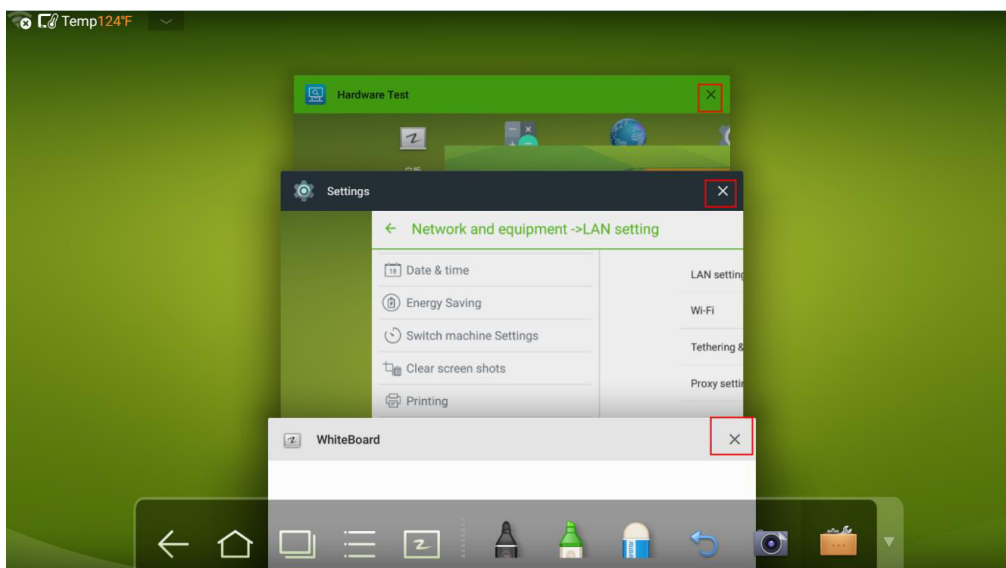

## Whiteboard

The whiteboard provides the writing function. In the whiteboard program, you can select a pen, line and color to write and use an eraser to erase content on the whiteboard. You can also print and clear the content on the whiteboard.

Click  on the toolbar or press **Whiteboard** on the remote controller to enter the whiteboard interface.

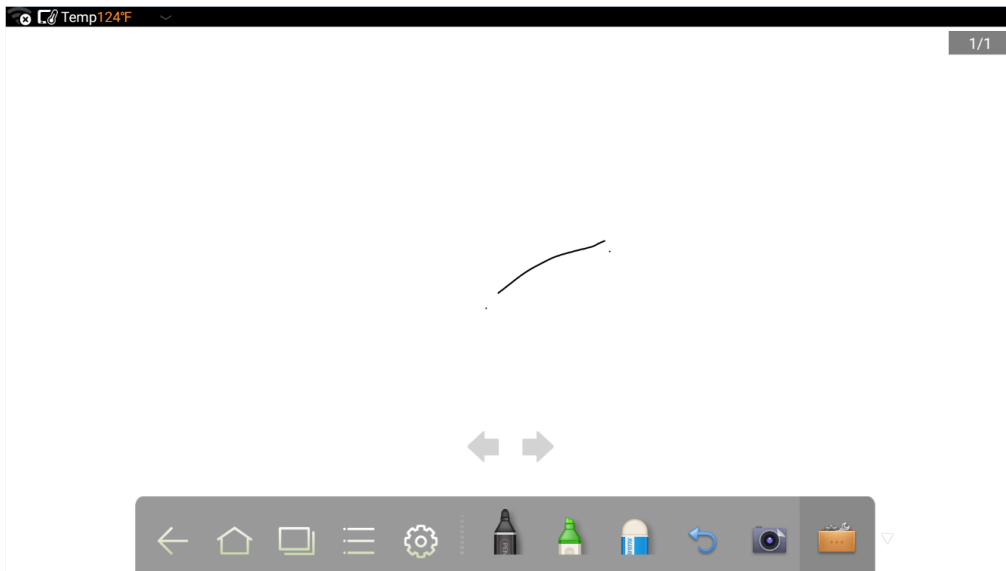

## New Whiteboard and Settings

Click  in the displayed menu, the functions of **New Page**, **Overview**, **Delete All** and **Settings** are listed.

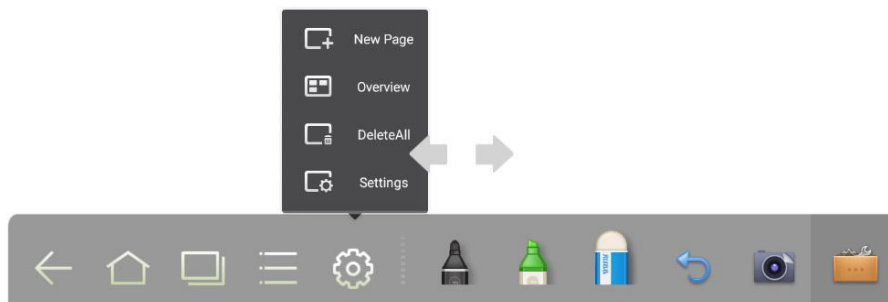

Click **Settings** to set the color and shade of the whiteboard, as shown in the following figure:

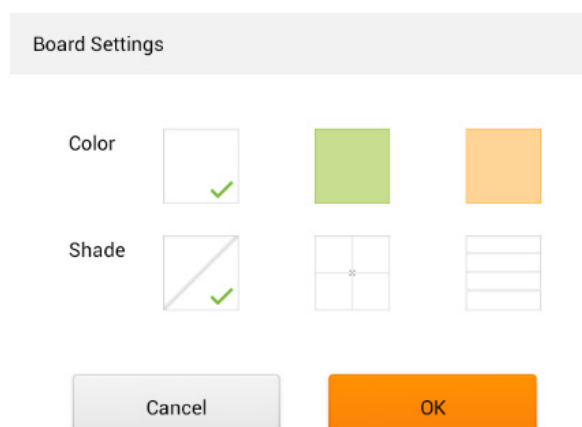

## Pen, Line Weight and Color

If the marker is selected, click and hold  for two seconds to set its line weight and color.



If the highlighter is selected, click and hold  for two seconds to set its line weight and color.

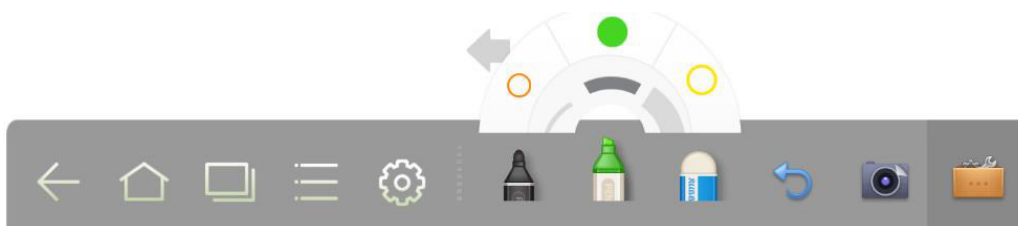

## Eraser

Two methods are available to erase written errors or content as follows:

- Click  to select the eraser, and then you can use it to erase the content on the whiteboard.
- Use five fingers to touch the screen and a circle is displayed indicating the scope for erasing. Move the circle to erase the content you wrote.



## Cancel



Click  to cancel operations.

## Screen Capture

The following two methods are used to capture screen:

- Click  to capture current content on the whiteboard and save it as an image in **Screenshots** directory. (The toolbar is not captured in the image.)
- Press **CAPTURE** on the remote controller to save current content on the whiteboard as an image in **Pictures > Screenshots** directory in the file manager.

You can open the directory by two ways:

- Go back to the home page and click  on the toolbar to enter the file manager. In the system file, find and click the **Screenshots** folder to check.
- Click  application programs to enter the image browsing interface. In the system file, find and click the **Screenshots** folder to check.

## Print, Clear and Freeze Screen

Click , **Print**, **Clear** and **Freeze screen** are displayed. Click **Print** to print current content on the whiteboard. Click **Clear** to clear all current content on the whiteboard. Click **Freeze screen** to capture the current screen and can do zoom in, zoom out, annotation on the freeze screen.

## Gallery

You can enter the gallery to view images one by one or play them as slides.

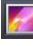
Click  in the application programs to enter the gallery. All folders containing images are displayed.

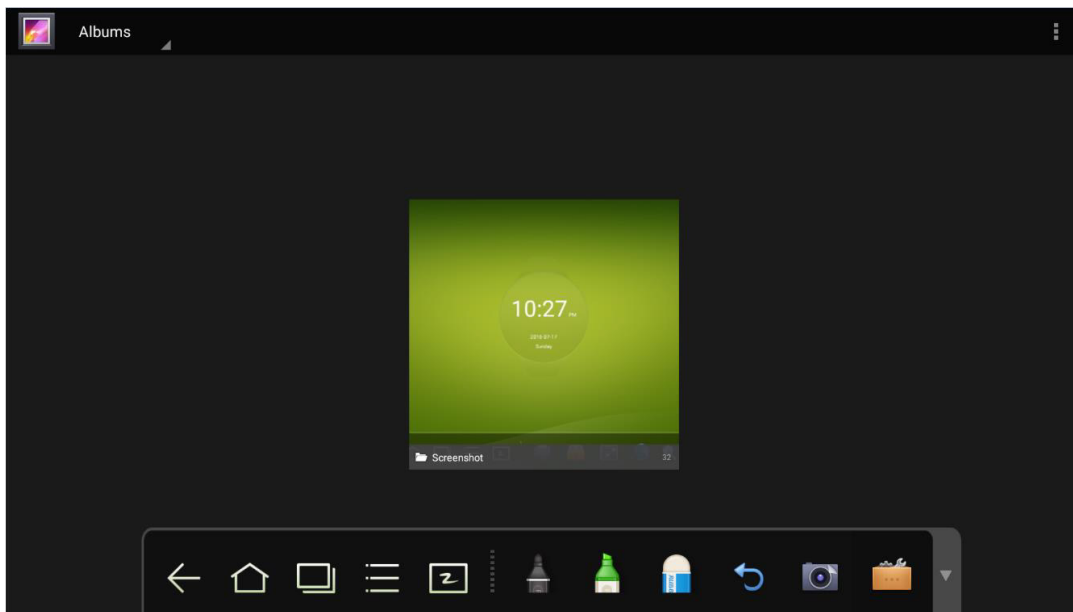

### •Full preview

One full screen can maximum display eight images, you can preview other group image by your finger slipping left or right. Using long press on screen to select multiple images, and then you can click  icon on the upper right corner to print, share, delete, edit, set and view detail of selected images.

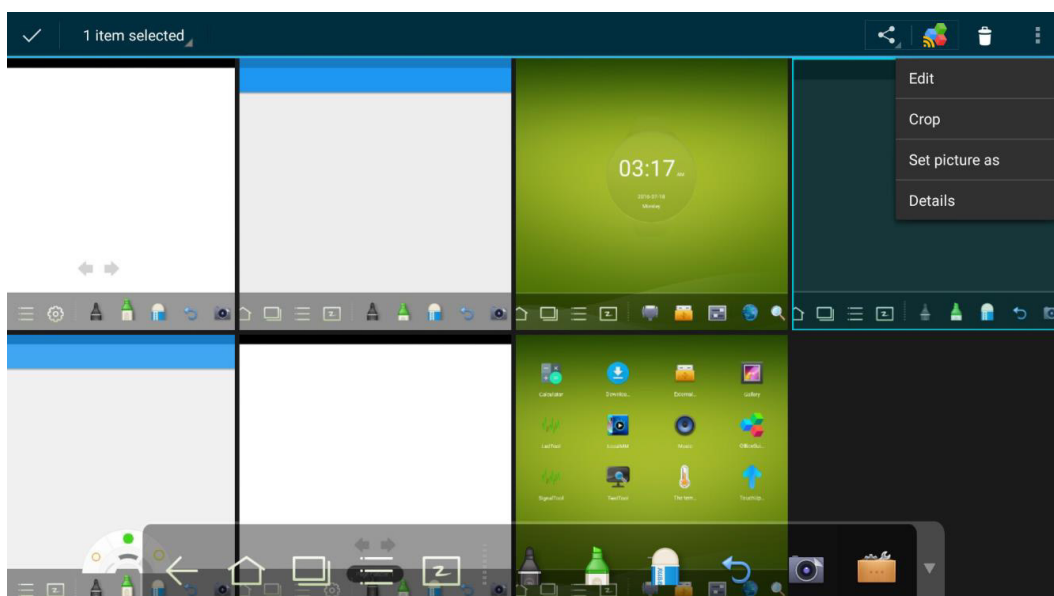



- View images one by one

Click one image in a folder. Scroll left to show the previous image and scroll right to show the next image.

- Play slides

Click  on the upper right corner of the folder and select Slideshow to play images as slides.

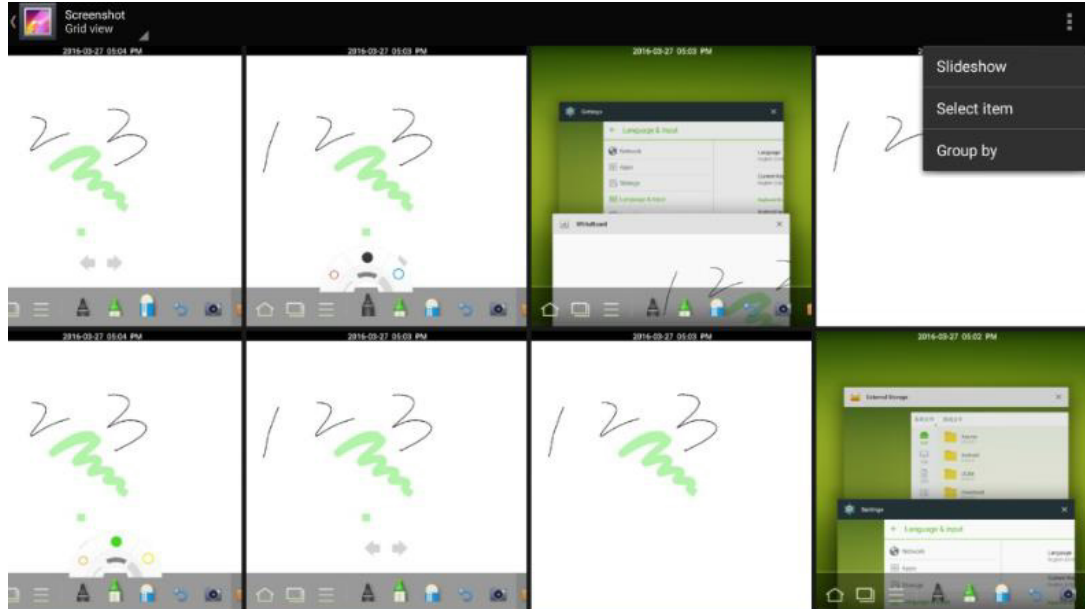

## File Manage

Click  on the toolbar to enter the file manager interface. Current system files are displayed. External device files are also displayed, such as the files in the SD card and USB drive. The file manager provides various functions, such as preview, filter, search, select, copy and delete files.

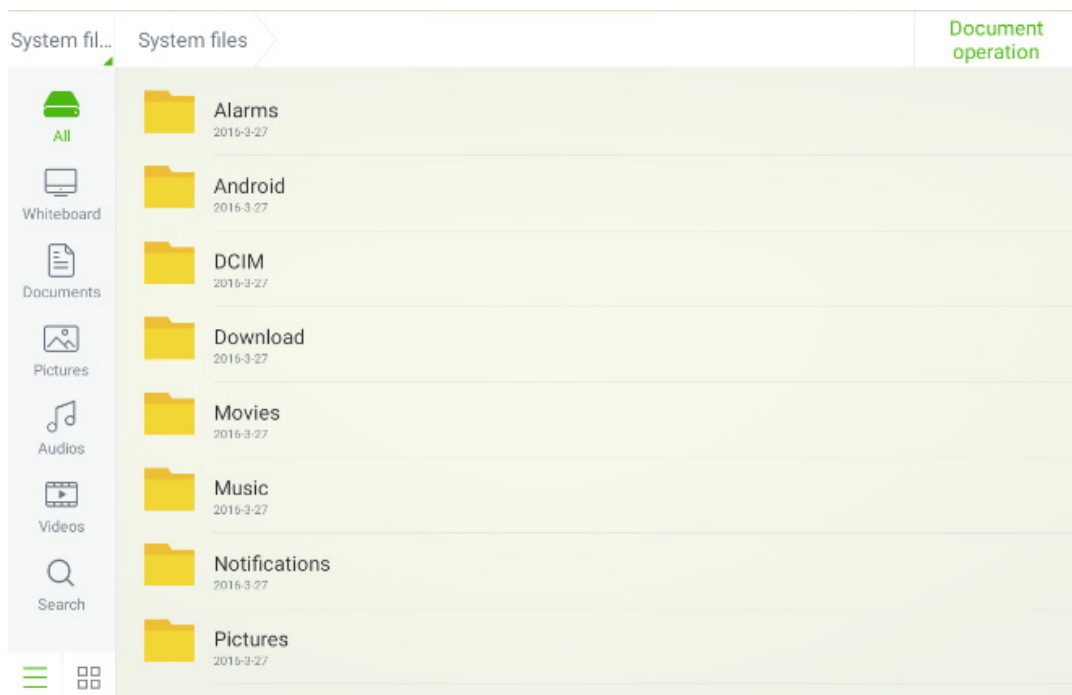

## Functions of the Remote Controller



Image	Fuction Discription
	On or standby
	Mute
0-9	Select TV channel or enter number
	Open the Android home page
	Go back or return to the parent menu.
	Show or hide munu
	Show or exit from the list of signal sources.
	Enable audio only mode.
	Freeze
	Up/Down/Left/Right direction buttons
	Confirm.
	Capture screen shots.
	Show the current signal source. You cannot show it in Android.
	Adjust screen displaying.
	Open WIFI on the computer.
	Change the display mode.
	Switch to the previous page on whiteboard software and PPT.
	Switch to the next page on whiteboard software and PPT.
	Open whiteboard software.
	Switch over to VGA signal source.
	Switch over to HDMI signal source.
	Switch over to OPS signal source.
	Zoom in and out.

## Instructions of Remote Controller

The effective area of the remote controller includes the vertical distance within five meters in front of the product, and the area within an angle of 30 degrees from the vertical point to the left and the right.

**Additional instructional resources are available on our website at:**

**<http://www.pnwboces.org/Internal-Departments/IT/Resources/EmployeeTrainingGuides.aspx>**

**For additional help please contact the PNW BOCES IT HelpDesk at 914-248-3888 (ext. 888 internally).**